

pg. 25-7

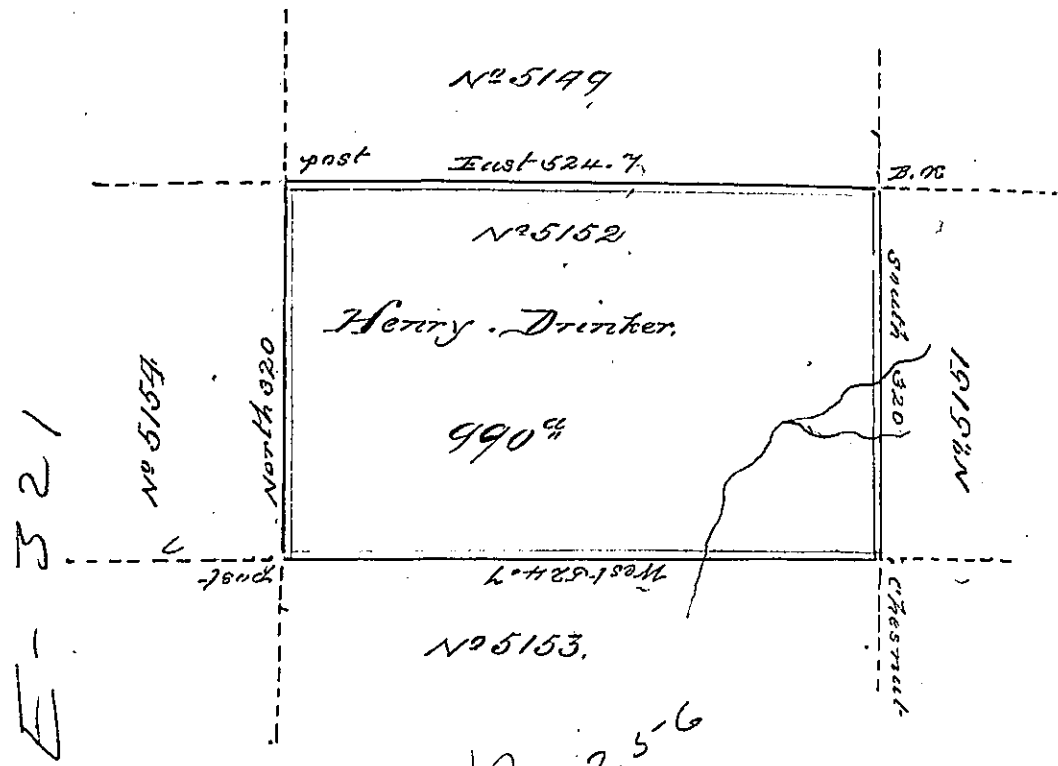

Surveyed the above described tract of Land on the eighth day of the seventh month 1794, for Henry Drinker Esquire in pursuance of his Warrant No 5152, dated Feby. 6<sup>th</sup> 1794. Situate on the waters of Kettle Creek. Adjoining as above described - Containing nine hundred & ninety acres, & the allowance of six per Cent.

William Ellis R. J.

Daniel Brockhead  
Esquire Surv. Genl.

IN TESTIMONY that the above is a copy of the original remaining on file in the Department of Internal Affairs of Pennsylvania, made conformably to an Act of Assembly approved the 16th day of February, 1833, I have hereunto set my Hand and caused the Seal of said Department to be affixed at Harrisburg, this

\_\_\_\_\_ Ninth day of April 1891

*Thos J. Stewart*  
Secretary of Internal Affairs